

June 6-8, 1991
Arizona State University
Tempe, AZ

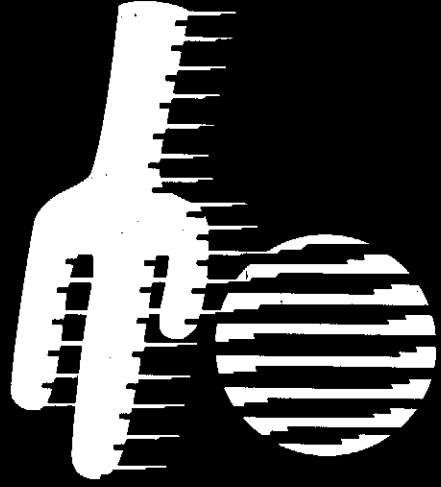

Community Research & Action

Third Biennial Conference on

*This conference is sponsored by
The Society For Community Research and Action
(Division 27 of the American Psychological Association)*

*The Planning Committee expresses its deep appreciation for the
financial contributions of several Arizona State University offices:*

Clinical Psychology Center
College of Liberal Arts and Sciences
Department of Psychology
Graduate College
Program for Prevention Research
Vice-President for Research

Conference Planning Committee:

Beth Shinn (Chair)
LaRue Allen
William S. Davidson
Ann D'Ercole
Melody G. Embree
Melvin N. Wilson

Site Committee:

Manuel Barrera, Jr. (Chair)
Irwin N. Sandler
Sharlene Wolchik
Alex J. Zautra

Student Award Recipients:

Diana Abramo (New York U)
Rebecca Campbell (U of Illinois-Urbana-Champaign)
Nancy A. Gonzales (U of Washington)
Mellen Kennedy (U of Illinois-Urbana-Champaign)
Marcia L. Michaels (Arizona State U)
Anne Morris (New York U)
Kelly Naylor (DePaul U)
Jorge I. Ramirez (U of Texas-El Paso)
Collin van Uchelen (U of Illinois-Urbana-Champaign)
Susan C. Yeich (Michigan State U)

Wednesday, June 5

1:00-5:00 p.m.

Preconference

Workshop:

Augustine

Community Development and Coalition Building--Critical Intervention for the 90's

Faculty: David Chavis (State U of New Jersey, Rutgers) & Thomas Wolff (Massachusetts Area Health Education Center)

Thursday, June 6

9:00-12:00 p.m.

Preconference

Workshop:

Augustine

Community Development and Coalition Building (continued)

Community Psychology Education and Training

The Council of Community Psychology Program Directors

1:00-1:50 p.m.

Paper

Xavier

Teaching Community Psychology: Talking of

Tips and Troubles

William B. Heil & Richard M. Zeigler (University of Illinois-Urbana-Champaign)

Symposium

Xavier

A Respite from the Ivory Tower: Michigan State's Practicum Experience

Chair: Karen Conroy

The Big Picture: Overview of the Practicum Experience

Melody G. Embree

Practicum Possibilities and Pitfalls

Kurt Ribisl & Karen Conroy

Student Experiences

Kimberly Eby & Terry Monaghan

Dolores

Enhancing the MA/PhD Collaboration in Community Psychology: A Discussion of the Possibilities

Chair: Patricia O'Connor (Russell Sage College)

2:00-2:50 p.m.

Xavier

Community Advocacy and Community Psychology Training: Explicating Roles and Relationships with Advocacy Groups

Chair: Christopher Keys (University of Illinois-Chicago)

3:00-3:50 p.m.

Xavier

Business Meeting

Chair: Patricia O'Connor (Russell Sage College)

Agenda:

1. Treasurer's Report (Christopher Keys)

2. Report on the Textbook Project

(William S. Davidson)

3. Results of Departmental Survey

(Kenneth I. Maton)

OPENING PROGRAM AND BANQUET

Ballroom

4:30-5:30 p.m.

Featured Speaker: M. Britton Lykes

(Rhode Island College)

Community Approaches to Mental Health Care for Children of War: International, Multidisciplinary Collaboration in Action

Research

Introduction by Anne Muvey (U of Lowell)

5:30-7:00 p.m.

Banquet

Beverly B. Long (National Prevention Coalition and National Mental Health Assn.)

Recipient, Distinguished Contributions to Practice in Community Psychology

Introduction by Jean Ann Linney (U of South Carolina)

7:30-8:45 p.m.

The Legacy of Martin Luther King for Community Psychology: Continuing the Dream

Chair: Marc A. Zimmerman (U of Michigan)

Participants: Christine Lijima Hall (Arizona State U), James G. Kelly (U of Illinois-Chicago), Blanca Ortiz-Torrez (New York U), & Lonnie Snowden (U of California-Berkeley)

Wednesday, June 5

1:00-5:00 p.m.

Reconference

Workshop:

Augustine

Community Development and Coalition Building--Critical Intervention for the 90's

Faculty: David Chavis (State U of New Jersey, Rutgers) & Thomas Wolff (Massachusetts Area Health Education Center)

Thursday, June 6

9:00-12:00 p.m.

Reconference

Workshop:

Augustine

Community Development and Coalition Building (continued)

Community Psychology Education and Training

The Council of Community Psychology Program Directors

1:00-1:50 p.m.

Paper

Xavier

Teaching Community Psychology: Talking of

Tips and Troubles

William B. Heil & Richard M. Zeigler (University of Illinois-Urbana-Champaign)

Symposium

Xavier

A Respite from the Ivory Tower: Michigan State's Practicum Experience

Chair: Karen Conroy

The Big Picture: Overview of the Practicum Experience

Melody G. Embree

Practicum Possibilities and Pitfalls

Kurt Ribisi & Karen Conroy

Student Experiences

Kimberly Eby & Terry Monaghan

Dolores

Enhancing the MA/PhD Collaboration in Community Psychology: A Discussion of the Possibilities

Chair: Patricia O'Connor (Russell Sage College)

2:00-2:50 p.m.

Xavier

Community Advocacy and Community Psychology Training: Explaining Roles and Relationships with Advocacy Groups

Chair: Christopher Keys (University of Illinois-Chicago)

3:00-3:50 p.m.

Xavier

Business Meeting

Chair: Patricia O'Connor (Russell Sage College)

Agenda:

1. Treasurer's Report (Christopher Keys)

2. Report on the Textbook Project

(William S. Davidson)

3. Results of Departmental Survey

(Kenneth I. Maion)

OPENING PROGRAM AND BANQUET

Ballroom

4:30-5:30 p.m.

Featured Speaker: M. Britton Lykes

(Rhode Island College)

Community Approaches to Mental Health Care for Children of War: International, Multidisciplinary Collaboration in Action

Research

Introduction by Anne Mulvey (U of Lowell)

5:30-7:00 p.m.

Banquet

Beverly B. Long (National Prevention Coalition and National Mental Health Assn.)

Recipient, Distinguished Contributions to Practice in Community Psychology

Introduction by Jean Ann Linney (U of South Carolina)

7:30-8:45 p.m.

The Legacy of Martin Luther King for Community Psychology: Continuing the Dream

Chair: Marc A. Zimmerman (U of Michigan)

Participants: Christine Iijima Hall (Arizona State U), James G. Kelly (U of Illinois-Chicago), Blanca Ortiz-Torrez (New York U), & Lonnie Snowden (U of California-Berkeley)

Two Sides of the Same Coin
Nichol Kim (U of Hawaii)

Critical Issues in the Study of Coping: Bridging

Generative and Intervention Research

Chair: Patrick H. Tolan (U of Illinois-Chicago)
Participants: Jean Ann Linney (U of South Carolina),
Patrick H. Tolan & Debbie Gorman-Smith, (U of
Illinois-Chicago), William C. Work (U of Rochester,
Or for Comm Change), Irwin N. Sandler, Wendy Kliever,
Sharlene Wolchik & Julie Lusting (Arizona State U)

Longitudinal Studies of Older Adult Health and

Mental Health

Chair: Alex J. Zaura (Arizona State U)
Negative Social Ties and Depressive Symptoms
John Finch (Arizona State U)
Effects of Coping Efficacy on Psychological Distress Among
Older Adults
Amy B. Wrabetz (Arizona State U)

Stress Inoculating Following Conjugal Bereavement
Charles A. Guarnaccia (U of North Texas)
The Relations of Physical and Mental Health in Older

Adults
John W. Reich, Kristi Erdal & Alex J. Zaura
(Arizona State U)
Discussant: Bruce Rapkin (New York U)

Roundtable/

Symposium

Cumpanite

Augustine

10:15-10:30 a.m.

Break

10:30-11:30 a.m.

Roundtable/

Symposium

Xavier

Identifying Innovative Uses of Qualitative

Methods in Research on Homelessness

Chair: Paul Toro (State U of New York-Buffalo)
The Health of Homeless People: An Historical Overview
Louisa R. Stark (Community Housing Partnership,
Phoenix)
Evaluating an Innovative Program for the Homeless Through
Investigative Reporting
Cheryl D. Bell (State U of New York-Buffalo)
Discussant: David L. Snow (U of Arizona)

8:30-10:15 a.m.

Public Hearing

Xavier

A Public Hearing on Behalf of Homeless

Children and Families

Co-Chairs: Ann D'Ercole (Manhattan Boverly
Corporation) & Norweeia Milburn (Holstra U)
Participants: Louisa R. Stark (Community Housing
Partnership, Phoenix), Beth Shinn (New York U),
Andrea L. Solarz (APA), Mary Jane Rothenam-Borus
(NYS Psych Institute), Kathleen Dockett (U District of
Columbia), Yvonne Raftery (Advocates for Children)

The Collaborative Research Process with

African American Leaders

Chair: James G. Kelly (U of Illinois-Chicago)
Community Contexts and Research Process
James G. Kelly (U of Illinois-Chicago)
Factors Affecting Leadership Emergence in The African
American Community
Lynne H. Mock (U of Illinois-Chicago)
Collaborative Research From The Perspective of a
Graduate Student
Cecile Lardon (U of Illinois-Chicago)
Discussants: Sandra Scheinfeld (Free Lance
Documenter) & Johnie Owens (Developing
Communities Project)

Asian Americans as Model Minorities: Myth

and Realities

Chairs: Nichol Kim & Maria Chun (U of Hawaii)
The Legal System and Asian Americans: Analyses of
Supreme Court Decisions
Robert H. C. Kim (Western Washington U)
Japanese American Internment Experience: From
Relocation to Redress
Harry H. L. Kitano (U of California - Los Angeles)
Asian Americans as Model Minorities: Social and
Psychological Implications
Renuka Sehi (California State U-Bakersfield)
Most Time, Hard Time
Chalisa Loo (U of Hawaii)
Educational Attainment of Japanese Americans: A
Contextual Model
Maria Chun (U of Hawaii)

Symposium

Symposium

Dolores

Symposium
Augustine

Sex Differences in the Development and

Treatment of Child Problems
Chair: Kate Kavanagh (Oregon Social Learning Center)
The Coercion Model: Generalization to Girls in Early Childhood

Beverly Fagot & Mark Eddy (Oregon Social Learning Center)

Differential Profiles of Preadolescents at-Risk for Drug Abuse

Kate Kavanagh (Oregon Social Learning Center)

Conduct Disordered Adolescents

Patricia Chamberlain (Oregon Social Learning Center)

Discussant: Gerald R. Patterson (Oregon Social Learning Center)

11:00-12:00 p.m.

Roundtable
Dolores

Culture-Base Theory and Interventions with Youth

Chair: Roderick J. Watts (DePaul U)
Manhood Development for African American Boys: Program and Organization Development

Roderick J. Watts (DePaul U)

Culture Sensitive Intervention in the Sexual Behavior of Adolescent Females

W. LaVonne Robinson, Peggy Watkins-Ferrell & Gloria Ramos (DePaul U)

Media-Based Aids Prevention in the Latino Community

Isiah Crawford (Loyola U) & Doreen Salina (DePaul U)

Cultural Issues in Services to Parenting Teens

Holly Ruck-Ross (Ounce of Prevention Fund)

Community Research and Action in Public Housing: Convergent Assumptions and Divergent Approaches

Chair: Mark S. Salzer (U of Illinois-Urbana-Champaign)
Participants: Mark S. Salzer, A. Michele Leasg, Eli Lieber & Ruby S. C. Phillips (U of Illinois-Urbana-Champaign)

10:30-12:00 p.m.

Poster Session
Ballroom 2 & 3

1. Rethinking the Role of Outreach in Overcoming Barriers to Care

Diana Abramo (New York U)

2. AIDS/HIV Education in Texas Schools: A Statewide Survey

Karen Basen-Engquist & Gloria Garcia (U of Texas Health Science Center-Houston)

3. Economic and Psychological Distress in Homeless Women

Holly A. Lizoite Binette, David Dowell & Pat Rozee (California State U-Long Beach)

4. The Rainbow Story: Community Change in Rural Australia

Brian Bishop (Curtin U, Australia), Geoff Syme (CSIRO, Australia) & Pam D'Rozario (U of WA)

5. Can Community Psychology Learn From Planners?

Geoff Syme (CSIRO, Australia) & Brian Bishop (Curtin U, Australia)

6. Understanding Battered Women's Decisions to Drop a Court Order of Protection

Rebecca Campbell & Karla Fischer (U of Illinois-Urbana-Champaign)

7. Crime, Social Status and Alienation

Martie Carson & Fran Norris (Georgia State U)

8. A Feminist Critique of the Mother's Role in Family Incest Theories

Charlene M. Eickholt (U of Virginia)

9. Is the Home Aging-Friendly? Home Visits with Older Adults

Maryan El-Faizy (U of California-Irvine) & Sibylle Reinsch (UCIMC)

10. Relationships, Residences, and Luggage: Experiences of Commuter Couples

Melody G. Embree (Michigan State U) & Carolyn W. Swift (U of Kansas)

11. Groups as Social Supports: Their Meaning in Elders' Social Networks

Barbara Felton, Carolyn Berry & Val Kanuha (New York U)

12. Independent Living Skills and Quality of Life

Adrian Fisher (Victoria U of Technology, Australia)

13. The Influence of Parenting on Adolescent Adjustment in African-American Families
Nancy A. Gonzales, Ana Mari Cauce & Craig Mason (U of Washington)

14. Stress Training and Research: Integrating Undergraduate Education, Applied Research, and Community Service
Barbara Coza (California State Polytechnic U), Kathy Grant (U of Vermont) & Linda Cozzens (California State Polytechnic U)

15. Participation: Empowering Organizational Members
William B. Heil (U of Illinois-Urbana-Champaign)

16. Teen Pregnancy Prevention: Programs That Work
Jean Hill (New Mexico Highlands U) & Peggy Walkin-Ferrell (Causes, Chicago, Ill)

17. Adolescents' Response to Suicidal Peers
John Kalabar (St Clare's Riverside Med Ctr) & Maurice Elias (Ruigers U)

18. An Introduction to Microcomputers in Qualitative Research
Melien Kennedy (U of Illinois-Urbana-Champaign)

19. The Achievement Motivation Across-Cultural-Research In Two Societies (Mexico and W. Germany)
Nuria Cifalo Lagos (U of Hawaii)

20. The Effects of Treatment on Juvenile Delinquents
Mark W. Lipsey (Claremont Graduate School)

21. The Social Ecology of Inpatient Dual-Diagnosis Treatment Settings
Douglas Luke, Bonnie Boots, Madeline Wordes & Kuri Ribisi (Michigan State U)

22. Validity Study of a Self-Selection Recruitment Procedure
Marcia L. Michaels, Mark W. Roosa (Arizona State U), & Leah K. Gensheimer (U of Missouri-Kansas City)

23. Impact of Pubertal Processes on Adolescents' Perceptions of Social Support
Ana Morita Moraes (New York U)

24. Gender Differences In Organizational and Social Factors Affecting Police Officers: A Levels of Analysis Perspective
Anne Morris (New York U)

25. Developing a Comprehensive Model of Sexual Assault Prediction
Kelly Naylor (DePaul U), Patrick H. Tolian (U of Illinois-Chicago) & Midge Wilson (DePaul U)

26. Lifetime and Past-year Incidence of Traumatic Life Events
Fran Norris & Betty Hanacek (Georgia State U)

27. Widowhood In Elderly Women
Julie Pellman (Columbia U)

28. The Influence of Acculturation on Family Functioning
Jorge I. Ramirez & Harmon M. Hosch (U of Texas-EI Paso)

29. Misperceptions and Attitude: Health Sciences Students at Senior Centers
Sibylle Reinsch, Marjan El-Faizy & Renee Nishimoto (U of California-Irvine)

30. Adolescents' Perceptions of Social Support: Esteem Enhancement and Esteem Threat
Jerome L. Short (George Mason U), Irwin N. Sandler & Mark W. Roosa (Arizona State U)

31. Challenging the Individualistic Bias in Control Constructs: A Collectivistic Alternative
Collin van Uchelen (U of Illinois-Urbana-Champaign)

32. Team Case Management for Homeless

Persons in Job Training
Cynthia Roberts-Gray (The Resource Group of Austin, Texas), Suzanne L. Wenzel (Ruigers U), & Donald J. Bauman (The Resource Group of Austin, Texas)

33. Empowering Homeless People to Create Structural Change: Preliminary Findings
Susan C. Yeich (Michigan State U)

34. Self-conceptions & Community

Interventions
Richard M. Zeigler (U of Illinois-Urbana-Champaign)

35. Support Networks for Families of Chronically Ill Children

Lina Beth Somera (Michigan State U)

12:00-1:00 p.m.

Ballroom

Lunch

1:00-2:00 p.m.

Ballroom

Featured Speaker: Gerardo Marin
(U of San Francisco)

Culturally Appropriate Community Interventions: How and Why?

Introduction by Lonnie Snowden (U of California-Berkeley)

2:00-2:15 p.m.

Break

2:15-4:15 p.m.

Panel

Discussion

Xavier

Visions for a Feminist Community Psychology
Chairs: Meg A. Bond & Anne Muirvey, (U of Lowell)

Panelists: Ana Marie Cauce (U of Washington),

Darlene Defour (Hunter College), Michelle Fine (U of

Pennsylvania), Christine Iijima Hall (Arizona State U-

West) & Margaret Schneider (The Ontario Institute

for Studies in Education)

Issues in Prevention Research on Adolescent Substance Use

Chair: Jacob K. Tebes (Yale U)

Early Childhood Predictors of Adolescent Substance Use

Michael W. Arthur, David L. Snow & Jacob K. Tebes

(Yale U)

Panel Attrition and Accretion in Adolescent Substance Use Research

Jacob K. Tebes, Michael W. Arthur & David L. Snow

(Yale U)

Roundtable/Symposium
Dolores

Workshop
Colonade

Conservation of Resources: Methods for Support Interventions Among Women

Presenter: Stevan E. Hobfoll (Kent State U)

Symposium
Cunpunle

HIV Prevention Among High Risk Youths: Gay Males, Lesbians, Runaways, Sex Offenders

Chair: Margaret Rosario (Columbia U)

HIV Prevention and Gay Male and Lesbian Youths

Margaret Rosario (Columbia U)

HIV Prevention and Male and Female Runaways

Mary Jane Rotheram-Borus (Columbia U)

HIV Prevention with Juvenile Male Sex Offenders

Judith Becker (U of Arizona) & Meg Kaplan

(Columbia U)

Discussant: Ed Seidman & Bruce Rapkin (New York U)

A Social Interactional Model of the Development and Prevention of Antisocial Behavior and Conduct Disorder

Chair: John B. Reid (Oregon Social Learning Center)

The Development of Disruptive Behavior Disorders

Lew Bank, Terry Duncan & Phil Fisher (Oregon Social Learning Center)

Generalization of Antisocial Behavior Across Settings

Betsy Ramsey (Oregon Social Learning Center), Hill Walker (U of Oregon) & Lew Bank (Oregon Social Learning Center)

Path to Delinquency: Additional Risk Factors

Gerald R. Patterson (Oregon Social Learning Center)

Parent Supervision, Child Wandering and Antisocial Behavior

Mike Stoolmiller (Oregon Social Learning Center)

Symposium
Augustine

Development and Prevention of Antisocial Behavior and Conduct Disorder

Chair: John B. Reid (Oregon Social Learning Center)

The Development of Disruptive Behavior Disorders

Lew Bank, Terry Duncan & Phil Fisher (Oregon Social Learning Center)

Generalization of Antisocial Behavior Across Settings

Betsy Ramsey (Oregon Social Learning Center), Hill Walker (U of Oregon) & Lew Bank (Oregon Social Learning Center)

Path to Delinquency: Additional Risk Factors

Gerald R. Patterson (Oregon Social Learning Center)

Parent Supervision, Child Wandering and Antisocial Behavior

Mike Stoolmiller (Oregon Social Learning Center)

Homelessness Among the Mentally Ill: Contributors,

Suzanne L. Wenzel (Ruigers U)

Interventions and Prevention Research and Evaluation in the Post-

Deinstitutionalization Era

Pamela M. Diamond (Hogg Foundation for Mental

Health, U of Texas)

The Shifting Location of Services for Children and Youth

Brian L. Wilcox (APA)

**Toward a Post-Modern Approach to
Community Research and Action**

Chair: J. R. Newbrough (Peabody College of Vanderbilt U)

Toward a Post-Modern Theory of Community

J. R. Newbrough (Peabody College of Vanderbilt U)

Generative/Reflective Practice

Paul R. Dokecki (Peabody College of Vanderbilt U)

Generative/Reflective Practice: A Community Case

Robert T. O'Gorman (Loyola U of Chicago)

Commentary: Modern and Post-Modern Approaches in

Robert Moroney (Arizona State U)

**An Examination of Diverse Community
Responses to Battered Women**

Chair: Cris M. Sullivan (Michigan State U)

Police Training and Battered Women

Joanne Belknap (U of Cincinnati)

Providing Intensive Advocacy Services to Women Leaving

Abusive Partners

Cris M. Sullivan & William S. Davidson (Michigan

State U)

Battered Women and the Courts: The Promise and

Problems of Orders of Protection

Karla Fischer (U of Illinois-Urbana-Champaign)

Risk and Protective Factors for Children in Stress

Chair: Irwin N. Sandler (Arizona State U)

Effects of Paternal Alcoholism, Social Support and

Conflict on Adolescent's Distress

Manuel Barrera, Jr., Laurie Chassin (Arizona

State U) & Fred Rogosch (U of Rochester)

Risk and Protective Factors for Mental Health Problems in

Bereaved Children

Irwin N. Sandler (Arizona State U), Joanne Gersten

(Arizona Dept of Health), Rafael Ramirez (U of

Puerto Rico) & Jenn Yun Tien (Arizona State U)

**Symposium
Colonnade**

**Symposium
Campus**

**Symposium
Augustine**

Parent Practices: Mediators of Risk for Antisocial

Behavior

Marion Forgatch (Oregon Social Learning Center)

John B. Reid (Oregon Social Learning Center)

Antisocial Youngsters: A Prevention Model

Participants: Yolanda Suarez-Balcazar, Layla

Sullivan, Isiah Crawford, Aaron Henderson, Christine

Smith (Loyola U of Chicago), Fabricio E. Balcazar (U

of Illinois-Chicago), Edison J. Trickett (U of

Maryland) & Roderick J. Watts (U of DePaul)

Break

Issues in Mutual-Help Research: Member Change

Chair: Melien Kennedy (U of Illinois-Urbana-Champaign)

From Social Support to Social Action

Catherine H. Stein & Ellen G. Bush (Bowling Green

State U), David A. Cislo (Wood County Mental

Health Center)

Ideology and Transformation in Mutual-Help Groups

Mellen Kennedy (U of Illinois-Urbana-Champaign)

Understanding Professionals' Views of Mutual-Help: An

Ecological and Comparative Approach

Mark Sabzer (U of Illinois-Urbana-Champaign), Lisa

McFadden (Ithaca College) & Julian Rappaport

(U of Illinois-Urbana-Champaign)

Preparing Professionals for Collaboration with Self-Help

Groups

Andy Farguharson (U of Victoria, Canada)

Deinstitutionalization Revisited: Implications

for Community Research and Action

Chair: Ira Iscoe (U of Texas-Austin)

Asylum and Community: The View from the Public Sector

Steven B. Schnee (San Antonio State Hospital)

Texas' Criminal Justice System: Moving Towards a System

of Care

Hugh F. Crean (Hogg Foundation for Mental Health,

U of Texas)

**Roundtable
Cavello**

**Symposium
Kavir**

**Symposium
Xavier**

**Symposium
Dolores**

Symposium Dolores

Supporting Health Action Coalitions: Collaboration with a Public Health Foundation
 Chair: Stephen B. Fawcett (U of Kansas)
Supporting a Foundation Initiative to Promote Health Through Community Development
 Stephen B. Fawcett, Adrienne L. Paine & Vincent T. Francisco (U of Kansas)
Monitoring and Evaluating Health Action Coalitions: Two Case Studies
 Vincent T. Francisco, Adrienne L. Paine & Stephen B. Fawcett (U of Kansas)
Applied Research in Community Health: A Case of Supermarket Interventions
 Adrienne L. Paine, Vincent T. Francisco, Stephen B. Fawcett (U of Kansas), Judy Johnson (Kansas LEAN Coalition) & Steve Coen (Wesley Foundation)
Discussant: Thomas Wolff (Massachusetts Area Health and Human Service Coalitions) & David Chavis (Ruigers U)

Symposium Colonnade

Theoretical Development and Community Applications
 Chair: Clifford R. O'Donnell (U of Hawaii)
Activity Settings and Community Development
 Clifford R. O'Donnell (U of Hawaii)
Providing Services to Culturally-Diverse Children: Theory and Opportunity
 Roland G. Tharp (U of California-Santa Cruz)
Youth Development within Community Settings: An Asset-Oriented Approach
 Kathleen Wilson (U of Hawaii)
Operative Principles of Community Empowerment
 Renee Furuyama (U of Hawaii)
The Activity Setting and Families
 Bob Ahlen-Widoe (U of Hawaii)
Culture by Design: Application of the Community Intervention Model
 Michael Manos (U of Hawaii)

Roundtable Campanile

Translating Empowerment into Everyday Action and Meaning
 Leaders: Bruce B. Roberts & Howard I. Thorsheim (St. Olaf College)

Family Correlates of Resilience in Bereaved Children
 Phyllis Silverman & William Worden (Harvard U)
Understanding Children's Divorce Adjustment from a Systems Perspective
 Lilliana Lengua, Sharlene Wolchik & Sanford Braver (Arizona State U)
Discussants: Ana Marie Cauce (U of Washington) & William Work (U of Rochester)

Is Community Psychology Relevant to Local Communities?
 Chair: Thomas Wolff (Massachusetts Area Health Education Center)

Ed Trickett, Folk Singer

Randy Kagan, Comedian

Nice Guys in Neckties, Rock-and-Roll Band

Peers and Self-Help Groups for Students: Innovative Programming and Research
 Chair: Louis Medvene (Claremont Graduate School)
Peer Strategies in Schools
 Audrey Garner & Frank Riessman (C.U.N.Y. Graduate School)
The Need for Mutual Help Groups on a College Campus
 Gregory J. Meissen & Mary Kendall (Wichita State U)
Self-Help Groups for Students Who Are Failing Academically
 Louis Medvene (Claremont Graduate School) & Ron Duran (U of California - Los Angeles)

Discussant: Thomas Powell (U of Michigan)

Public Forum Cavetto

Entertainment Mission Room

8:30 p.m.

9:15 p.m.

10:00 p.m.

Symposium Xavier

8:30-9:30 a.m.

Saturday, June 8

Consumer Involvement in Setting Agendas for

Symposium
Dolores

Change
Chair: Fabricio E. Balcazar (U of Illinois-Chicago)
Individual Level: Teaching VR Clients to Set Goals and
Recruit Help
Fabricio E. Balcazar (U of Illinois-Chicago)
Group Level: National Trends in the Advocacy Movement
of People with DD
Christopher Keys & Penny Foster-Fishman (U of
Illinois-Chicago)
System Level: Setting the Agenda for the Department of
Rehabilitation Services in Illinois
Timothy A. Andriano (Dept of Rehab Services
Illinois)
Discussant: J. R. Newbrough (Vanderbilt U)

The Scientist-Community Relationship
Revisited: Progress Toward an Effective Model
of Collaborative Action
Chair: Thom Moore (U of Illinois-Urbana-Champaign)
Presenters: Thom Moore & David Dubois (U of
Illinois-Urbana-Champaign)

The Community Psychologist, the Mental Health
System and the Chronically Mentally Ill:
Collaboration, Conflict and Commitment
Chair: Catherine H. Stein (Bowling Green State U)
Participants: Catherine H. Stein & Marcia Ward
(Bowling Green State U), David A. Cislo (Wood County
Mental Health Center)

Systemic Impacts of Suspected Child Abuse:
Reporting, Investigation and Prosecution
Chair: N. Dickon Reppucci (U of Virginia)
Child Abuse Reporting Laws: Are They Working?
N. Dickon Reppucci (U of Virginia)
State Child Protective Social Workers: Authority or
Confidant?
Sarah Cook (U of Virginia)
Balancing Children's Interests and Defendants' Rights in
the Courtroom
Catherine A. Crosby (U of Virginia)
Discussant: Mark S. Aber (U of Illinois-Urbana-
Champaign)

Systemic Impacts of Suspected Child Abuse:
Reporting, Investigation and Prosecution
Chair: N. Dickon Reppucci (U of Virginia)
Child Abuse Reporting Laws: Are They Working?
N. Dickon Reppucci (U of Virginia)
State Child Protective Social Workers: Authority or
Confidant?
Sarah Cook (U of Virginia)
Balancing Children's Interests and Defendants' Rights in
the Courtroom
Catherine A. Crosby (U of Virginia)
Discussant: Mark S. Aber (U of Illinois-Urbana-
Champaign)

Systemic Impacts of Suspected Child Abuse:
Reporting, Investigation and Prosecution
Chair: N. Dickon Reppucci (U of Virginia)
Child Abuse Reporting Laws: Are They Working?
N. Dickon Reppucci (U of Virginia)
State Child Protective Social Workers: Authority or
Confidant?
Sarah Cook (U of Virginia)
Balancing Children's Interests and Defendants' Rights in
the Courtroom
Catherine A. Crosby (U of Virginia)
Discussant: Mark S. Aber (U of Illinois-Urbana-
Champaign)

Expectancy Processes in Urban Schools: From
Basic Research to Intervention
Chair: Rhona S. Weinstein (U of California-Berkeley)

Symposium
Augustine

Teacher Expectations, Classroom Environments, and the
Internal World of Children
Meryl Boikin (U of California-Berkeley)
Teacher-Researcher Collaboration to Raise Expectations:
The Process
Rhona S. Weinstein (U of California-Berkeley)
Consultation Effects on Teachers' Sense of Efficacy and
Student Self-Expectations
Ruth Goldman (San Francisco State U) & Meryl
Boikin (U of California-Berkeley)
Individual and System Constraints in Changing
Expectations
Sybil Madison, Margaret Kuklinski & Rhona S.
Weinstein (U of California-Berkeley)
Discussant: Edison J. Trickett (U of Maryland)

9:30-9:45 a.m.

Break

Methodological Advances in Self-Help Research
Chair: Douglas Luke (Michigan State U)
Group Helping Ecology & the Disbanding of Mutual-Help
Groups: A Predictive Study
Kenneth I. Maion (U of Maryland-Baltimore),
Barbara White & Marisa Julien (New Jersey
Self-Help Clearinghouse)
Measuring Change in a Self-Help Group: Outcome
Redefined
Douglas Luke (Michigan State U)
Self-Help in Group Homes: A Collaborative Case Study
Deborah A. Salem (U of Michigan Institute for
Social Research)
Development of an Ongoing Action Research Project in a
Mutual-Help Center
Gregory J. Meissen, Doug Richards, Lee Herring,
Rhonda K. Williams & Suzan K. Hudson (Wichita
State U)
Discussant: Ed Seidman (New York U)

9:45-10:45 a.m.

Symposium
Xavier

Roundtable
Campanile

Systemic Impacts of Suspected Child Abuse:
Reporting, Investigation and Prosecution
Chair: N. Dickon Reppucci (U of Virginia)
Child Abuse Reporting Laws: Are They Working?
N. Dickon Reppucci (U of Virginia)
State Child Protective Social Workers: Authority or
Confidant?
Sarah Cook (U of Virginia)
Balancing Children's Interests and Defendants' Rights in
the Courtroom
Catherine A. Crosby (U of Virginia)
Discussant: Mark S. Aber (U of Illinois-Urbana-
Champaign)

Symposium
Augustine

Systemic Impacts of Suspected Child Abuse:
Reporting, Investigation and Prosecution
Chair: N. Dickon Reppucci (U of Virginia)
Child Abuse Reporting Laws: Are They Working?
N. Dickon Reppucci (U of Virginia)
State Child Protective Social Workers: Authority or
Confidant?
Sarah Cook (U of Virginia)
Balancing Children's Interests and Defendants' Rights in
the Courtroom
Catherine A. Crosby (U of Virginia)
Discussant: Mark S. Aber (U of Illinois-Urbana-
Champaign)

Qualitative Data Analysis: Examples from an AIDS Prevention Evaluation Project
 Chair: Marc A. Zimmerman (U of Michigan)
 Participants: Marc A. Zimmerman, Barbara A. Israel, Marshall H. Becker, Myrna Cozen & Nancy Janz (U of Michigan), Nicholas Freudenberg (Hunter College)

1. Social Development Correlates of Adolescent Antisocial Behavior
 Michael W. Arthur (Yale U)

2. Federal Perspectives on Mutual Self-Help Research and Action
 Thomasina Borkman (George Mason U) &

3. Federal Funding of Preventive Interventions with Mutual Support
 Dorothy Goldklang (NIMH)

4. Evolution and Change in the Expression of Psychological Disorders
 Martin Costa (U of Southern California)

5. Hassles, Social Support, Adaptive Coping, and Adolescent Depression: An Integrative Model
 Hugh F. Crean (U of Texas)

6. LINC: Managed Community Systems for Children with Special Health Needs
 Barbara W. Desguin (Michigan State U) & Karen Boyd (Community Health Association)

7. The Urgent Need for Legal Intervention: Lives of Battered Women
 Kimberly Eby (Michigan State U)

8. Children's Post-divorce Adjustment: Interactions of Age, Gender, and Interparental Conflict
 Pamela Fitzpatrick, Sharlene Wolchik, & Sanford Braver (Arizona State U)

Roundtable
 Augustine

11:00-12:30 p.m.
 Poster Session
 Ballroom 2 & 3

Enhancing Higher Education Opportunities for Minorities Through Business/Education Partnerships

Chair: Susan M. Wolfe (Michigan State U)
 Design, Development and Implementation of an Innovative Program

Naomi R. Garrett (Dallas County Community College District)
 The Corporate Perspective and Community Intervention Efforts

Ray Reed (Rockwell International Corporation)
 Enhancing Person-Environment Fit on a Community College Campus

Joel L. Riley (Cedar Valley College)
 Project MEET Evaluation Results and Future Directions

Susan M. Wolfe (Michigan State U)

Symposium
 Cavetto

10:45-11:00 a.m.

Roundtable
 Xavier

11:00-12:00 p.m.

Community Psychologists in Public Policy: Seeing Research in Action

Chair: Brian L. Wilcox (APA)
 Participants: Carolyn L. Feis (U.S. General Accounting Office), Mitchell M. Handelsman (U of Colorado-Denver), Denis Nissim-Sabat (Mary Washington College), Andrea L. Solarz (APA)

Understanding Mentoring Among African American Youth: A Collaborative Approach
 Chair: Nancy Burgoyne (U of Illinois-Chicago)

History, Evolution and Conceptual Roots of LEAP
 Paul Dolinko (NIC/Institute for Juvenile Research)
The Stages of an Ecologically Valid Evaluation
 Nancy Burgoyne (NIC/Institute for Juvenile Research)

Issues of Cultural Sensitivity in the LEAP Project
 Derise Tolliver (DePaul U)
 Discussant: James G. Kelly (U of Illinois-Chicago)

Panel
 Discussion
 Dolores

11:30-12:30 p.m.

Images and Sounds of Neighborhood Life
 Presenter: Bill Berkowitz (Arlington, MA)

Slide Show & Discussion
 Colonnade

18. Programming Methods for Computer Assisted Interviews in Divorcing Family Studies
Teresa Dingus McElroy (Arizona State U)

19. Weight Management Programs: Comparison of the Focal Points for Contracts
Terry Monaghan (Michigan State U)

20. Politics and Community Psychology in Portugal
Jose Ornelas (Associaçao Para o Estudo e Integracao Psicossocial)

21. Mentoring and Resilience Among Innercity Pregnant Teenagers
Jean Rhodes, Lori Ebert, & Susan Englund (U of Illinois-Urbana-Champaign)

22. Employee Perceptions of the Workplace: A Health-strengthening Environment Measure
Kurt Ribisi (Michigan State U)

23. Home Visiting and Family Support: What Communities Are Doing Now
Richard N. Roberts (Utah State U)

24. Family Centered Early Intervention Systems for Navajo Families
Richard N. Roberts (Utah State U)

25. An Evaluation of a School-based Substance Abuse Prevention Program
Carron Rurnik & Marion Terenzio (Russell Sage College)

26. Factors Influencing Corporate Participation in a Worksite Smoking Cessation Research Program
Doreen Salina & Leonard Jason (DePaul U)

27. Evaluation of a Third Generation Preventive Intervention for Children of Alcoholics
Rita Shell & Mark W. Roosa (Arizona State U)

28. Strengthening the Effects of Parent Training in Prevention and Treatment Programs: The Value of Problem-solving Skills Training
Steve Spaccarelli (Arizona State U)

9. Effects of Maternal Monitoring on Aversive Mother-son Exchanges
William Griffin (Arizona State U), William Gardner (Western Psychiatric Institute), John B. Reid, & Gerald R. Patterson (Oregon Social Learning Center)

10. The Relationship Between Interparental Consistency in Parenting and Child Behavior
Nancy Groppenbacher & Mark W. Roosa (Arizona State U)

11. Why Homosexual Men Don't Use Condoms: Implications for Interventions
Janet Harrison (Georgia State U), Gail Bolan, & Nancy Hessel (San Francisco Dept. of Public Health)

12. In Search of "Altruistic Community": Social Support Following Hurricane Hugo
Krzysztof Kaniasy (Indiana U of Pennsylvania) & Fran Norris (Georgia State University)

13. Development of Social Competence: Autonomy, Relatedness and Interpersonal Negotiation Strategies
Gabriel Kuperminc (U of Virginia) & Michael W. Arthur (Yale U)

14. Development of a Community Attitude Scale Toward Mentally Ill People
Diane Laffeur & Francine Lavoie (Universite Laval, Canada)

15. Doctors and Nurses Attitudes When Confronted with Wife Abuse
Francine Lavoie (Universite Laval, Canada), M. Jacob (Universite du Quebec a Montreal), & G. Martin (Universite Laval, Canada)

16. Event Characteristics and Coping with Children's Divorce-related Stressors
Julie Lusting, Irwin N. Sandler, Tim S. Ayers, & Jane Bernzweig (Arizona State U)

17. Multidimensional Acculturation and Adjustment Among Latinos
Belizario Magana (U of Southern California)

2:00-3:00 p.m.

Ballroom

Featured Speaker: Gerald R. Patterson
(Oregon Social Learning Center)
The Effects of Context on Family Process
Introduction by Irwin N. Sandler (Arizona State U)

3:00-3:15 p.m.

Break

3:15-4:30 p.m.

Symposium

Impact of Work, Family and Child Care on Working Parents
Chair: Diane Hughes (New York U)
Family Role Strain, Occupational Stressors and Health and Well-Being
Chaya Piotrkowski, Kevin Coray & Barbara Cohen
(National Council of Jewish Women)
The Relationship Between Parents and Teachers in Child Care Centers
Beth Shinn (New York U), Ellen Galinsky
(Families and Work Institute), Leyla Gulcur (New York U), Deborah Phillips (U of Virginia), Carollee Howes (U of California-Los Angeles) & Marcy Whitebook (The Child Care Employee Project)
The Impact of Job Stress on Family Functioning
Joe Kosciw & Diane Hughes (New York U)
A Worksite Coping Skills Intervention with Female Employees: Effects on Psychological Symptomatology and Substance Use
David L. Snow & Marsha L. Kline (Yale U)
Discussant: Diane Hughes (New York U)

Roundtable
Dolores

Tailoring Research Methods to Participants' Needs and Situations
Chair: Cris M. Sullivan (Michigan State U)
Research & Social Action: Assisting Women with Abusive Partners
Cris M. Sullivan & William S. Davidson (Michigan State U)
Design Evaluations in Collaborative Evaluation: The Joy of Squeezing Lemons
Thomas M. Reitsch & Madeline Wordes (Michigan State U)

29. A Conceptual Analysis of Empirical Research in Community Psychology: 1985-1989
Paul Speer & Joseph Hughey (U of Missouri-Kansas City)

30. Social Ecology of Adolescents: Report of a Longitudinal Project
Edison J. Trickett, Kathleen Schmid, & Peter Leone (U of Maryland)

31. Understanding Risk, Fear of Cancer and Other Public Concerns about Hazardous Chemicals
Abraham Wandersman (U of South Carolina) & William Hallman (Rutgers U)

32. Perceived Costs and Benefits of Membership in a Self-Help Group: Comparison of Members and Nonmembers of the Alliance for the Mentally III
Shelley Norton, Abraham Wandersman & Charles Goldman (U of South Carolina)

33. The Context of Socialization in Diverse Black Family Structures: Nonmaternal Adults' Influences on Mother's Role
Laura Kohn, Judy Curry-El, Lan Do, Ivora Hinton, Alex Underwood, & Melvin N. Wilson (U of Virginia)

34. Content Analysis of Parent-child Interactions in Diverse Black Families
Ivora Hinton, Melvin N. Wilson, Hope Solomon, Ursula Smith, Jennifer Boyer, & Angela McElroy (U of Virginia)

Lunch (opportunity for special group meetings)

12:30-2:00 p.m.

Xavier

Dolores

Campante

Cavello

Augustine

22

Children and Youth Self-Help/Mutual Support Interest Group
Rocky Mountain Region Aging Interest Group
Applied Interest Group

Paraprofessional Support in a Family Nurture Program: Conceptual and Methodological Considerations
 Craig C. Brookins (North Carolina State U)
School-Based Interventions: A Methodologically "Risky" Endeavor for At-Risk Populations
 Leah K. Gensheimer (U of Missouri-Kansas City),
 Tim S. Ayers & Mark W. Roosa (Arizona State U)
 Discussant: James G. Kelly (U of Illinois-Chicago)

Preparing Professionals for Collaboration with Self-Help Groups
 Presenter: Andy Farquharson (U of Victoria, Canada)

Multiple-Level Prediction of Depression and Delinquency in Urban Minority Adolescents
 Chair: Patrick H. Tolan (U of Illinois-Chicago)

Stress and Coping Model for Delinquent and Depressed Adolescents
 Caryn Blitz (DePaul U)

The Experience of Peer Relationship of Depressed and Delinquent Adolescents
 Linda Schwarz-Dodek (DePaul U)

Family Support and Criminal Behavior and Adolescent Depression and Delinquency
 Joe Scally (DePaul U)

Adolescents' Perception of Community Resources and Psychopathology
 Alban Fisher (DePaul U)

Integrating Levels of Predictors of Adolescent Delinquency and Depression
 Patrick H. Tolan (Institute for Juvenile Research, U of Illinois-Chicago)

Teaching Empowerment in Disempowering Settings: Feminism, Community Psychology and Pedagogy
 Chair: Margaret Schneider (Ontario Institute for Studies in Education, Canada)

Participants: Margaret Schneider (Ontario Institute for Studies in Education), Anne Mulvey & Meg A. Bond (U of Lowell)

Workshop

Columnade

Symposium

Augustine

Roundtable

Cavetto

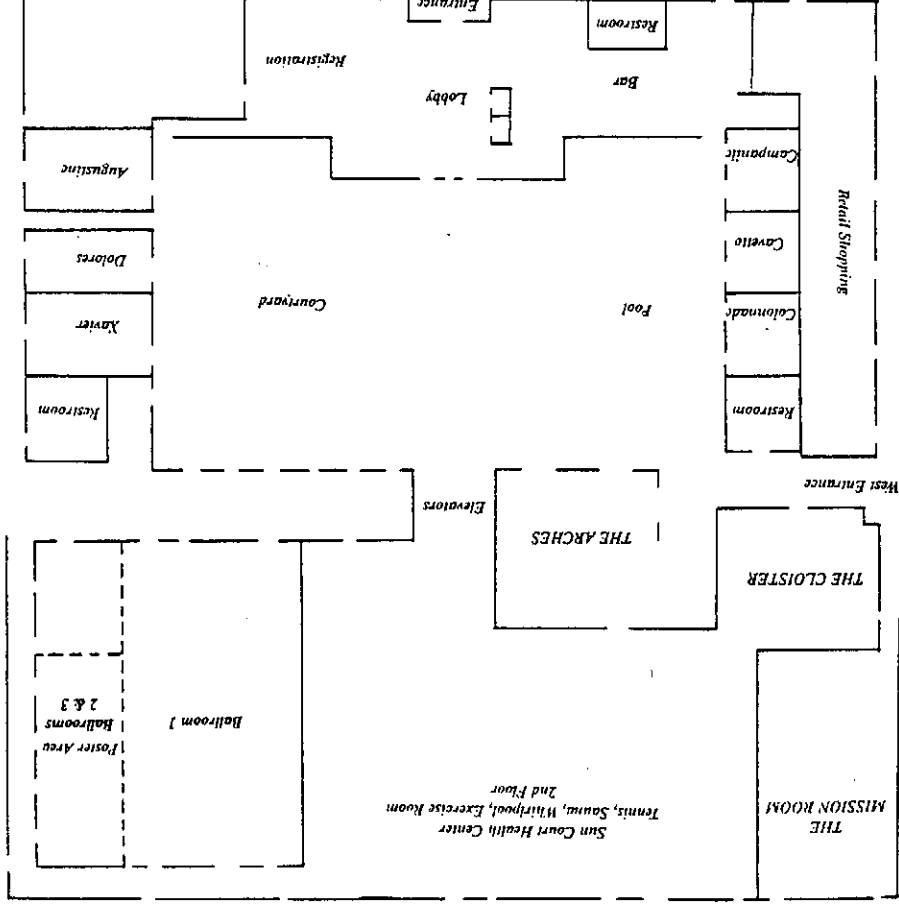

Third Biennial Conference Program Summary - Friday, June 7, 1991

| <i>Time</i> | <i>Xavier</i> | <i>Dolores</i> | <i>Colonnade</i> |
|-------------|--------------------------------------------------------------------------------------------------------------------|---------------------------------------------------------------------------------------------------------------|--------------------------------------------------------------------------------------------------|
| 8:30 | | | |
| 9:00 | <i>Public Hearing A Public Hearing on Behalf of Homeless Children and Families</i> | | |
| 9:30 | | <i>Symposium The Collaborative Research Process with African American Leaders</i> | <i>Symposium Asian Americans as Model Minorities: Myth and Realities</i> |
| 10:00 | | | |
| 10:30 | <i>Break</i> | | |
| 11:00 | <i>Roundtable/Symposium Identifying Innovative Uses of Qualitative Methods in Research on Homelessness</i> | | |
| 11:30 | | <i>Roundtable Culture-Base Theory and Interventions with Youth</i> | <i>Roundtable Community Research and Action in Public Housing</i> |
| 12:00 | | | |
| 12:30 | | | |
| 1:00 | | | |
| 1:30 | | | |
| 2:00 | | | |
| 2:30 | <i>Break</i> | | |
| 3:00 | <i>Panel Discussion Visions for a Feminist Community Psychology</i> | <i>Roundtable/Symposium Issues in Prevention Research on Adolescent Substance Use</i> | <i>Workshop Conservation of Resources: Methods for Support Interventions Among Women</i> |
| 3:30 | | | |
| 4:00 | | | |
| 4:30 | | | |
| 5:00 | <i>Break</i> | | |
| 5:30 | <i>Symposium Issues in Mutual-Help Research: Member Change and Professional Roles</i> | <i>Symposium Deinstitutionalization Revisited: Implications for Community Research and Action</i> | <i>Symposium Toward a Post-Modern Approach to Community Research and Action</i> |
| 6:00 | | | |

Third Biennial Conference Program Summary - Friday, June 7, 1991

| <i>Time</i> | <i>Campanile</i> | <i>Augustine</i> | <i>Cavetto</i> | <i>Ballrooms</i> |
|-------------|------------------------------------------------------------------------------------------------------------------------|-------------------------------------------------------------------------------------------------------------------------------------------------|---------------------------------------------------------------------------------------------|--------------------------------------------|
| 8:30 | | | | |
| 9:00 | <i>Symposium Critical Issues in the Study of Coping: Bridging Generative and Interventive Research</i> | <i>Symposium Longitudinal Studies of Older Adult Health and Mental Health</i> | | |
| 9:30 | | | | |
| 10:00 | | | | |
| 10:30 | | | | |
| 11:00 | | <i>Symposium Sex Differences in Development & Treatment of Child Problems</i> | | <i>Poster Session</i> |
| 11:30 | | | | |
| 12:00 | | | | |
| 12:30 | | | | <i>Lunch</i> |
| 1:00 | | | | <i>Featured Speaker: Gerardo Marin</i> |
| 1:30 | | | | |
| 2:00 | | | | |
| 2:30 | <i>Break</i> | | | |
| 3:00 | <i>Symposium HIV Prevention Among High Risk Youths: Gay Males, Lesbians, Runaways, Sex Offenders</i> | <i>Symposium A Social Interactional Model of the Development and Prevention of Antisocial Behavior and Conduct Disorder</i> | <i>Roundtable Issues of Cultural Diversity in Community Psychology Programs</i> | |
| 3:30 | | | | |
| 4:00 | | | | |
| 4:30 | | | | |
| 5:00 | <i>Break</i> | | | |
| 5:30 | <i>Symposium An Examination of Diverse Community Responses to Battered Women</i> | <i>Symposium Risk and Protective Factors for Children in Stress</i> | <i>Public Forum Is Community Psychology Relevant to Local Communities?</i> | |
| 6:00 | | | | |

| Third Biennial Conference Program Summary - Saturday, June 8, 1991 | | | |
|--------------------------------------------------------------------|----------------------------------------------------------------------------------------------|-----------------------------------------------------------------------------------|--------------------------------------------------------------------------------|
| Time | Xavier | Dolores | Colonnade |
| 8:30 | | | |
| 9:00 | Symposium Peers and Self-Help Groups for Students: Innovative Programming and Research | Symposium Supporting Health Action Conditions | Symposium Theoretical Development and Community Applications |
| 9:30 | | | |
| 10:00 | Symposium Methodological Advances in Self-Help Research | Break | Break |
| 10:30 | | Symposium Consumer Involvement in Setting Agendas for Change | Presentation & Discussion The Scientist-Community Relationship Revisited |
| 11:00 | | | |
| 11:30 | Roundtable Community Psychologists in Public Policy | Panel Discussion Understanding Mentoring Among African American Youth | Slide Show & Discussion Images and Sounds of Neighborhood Life |
| 12:00 | | | |
| 12:30 | | | |
| 1:00 | | | |
| 1:30 | Children and Youth | Self-Help/Mutual Support Interest Group | |
| 2:00 | | | |
| 2:30 | | | |
| 3:00 | | | |
| 3:30 | Symposium Impact of Work, Family and Child Care on Working Parents | Break | Break |
| 4:00 | | Roundtable Tailoring Research Methods to Participants' Needs and Situations | Workshop Preparing Professionals for Collaboration with Self-Help Groups |
| 4:30 | | | |

| Third Biennial Conference Program Summary - Saturday, June 8, 1991 | | | | |
|--------------------------------------------------------------------|-------------------------------------------------------------------------------|----------------------------------------------------------------------------------------------------------|----------------------|---------------------------------------------------------------------------------------|
| Time | Campanile | Augustine | Cavetto | Ballrooms |
| 8:30 | Roundtable Translating Empowerment into Everyday Action and Meaning | Symposium Expectancy Processes in Urban Schools | | |
| 9:00 | | | | |
| 9:30 | | | | |
| 10:00 | Roundtable Psychologists, the Mental Health System and the Mentally Ill | Symposium Systemic Impacts of Suspected Child Abuse | Break | Symposium Enhancing Higher Education Opportunities for Minorities |
| 10:30 | | | | |
| 11:00 | | | | |
| 11:30 | | | | |
| 12:00 | | Roundtable Qualitative Data Analysis: AIDS Prevention Project | | Poster Session |
| 12:30 | | | | |
| 1:00 | Rocky Mountain Region | | | |
| 1:30 | | Applied Interest Group | Aging Interest Group | Lunch |
| 2:00 | | | | |
| 2:30 | | | | |
| 3:00 | | | | Featured Speaker: Gerald R. Patterson |
| 3:30 | | | | |
| 4:00 | | Symposium Multiple-Level Prediction of Depression and Delinquency in Urban Minority Adolescents | Break | Roundtable Teaching Empowerment: Feminism, Community Psychology and Pedagogy |
| 4:30 | | | | |

- Aber, Mark S. 17
 Abram, Diana 1,6
 Ahlen-Widoe, Bob 15
 Allen, Larue 1
 Andriano, Timothy A. 17
 Arthur, Michael W. 10,11,19,20
 Ayers, Tim S. 20,24
 Balcazar, Fabricio E. 12,17
 Bank, Lew 11
 Barrera, Jr., Manuel 1,13
 Basen-Engquist, Karen 7
 Bauman, Donald J. 9
 Becker, Judith 11
 Becker, Marshall H. 19
 Belknap, Joanne 13
 Bell, Cheryl D. 5
 Berkowitz, Bill 18
 Bernzweig, Jane 20
 Berry, Carolyn 7
 Binette, Holly A. Lizotte 7
 Bishop, Brian 7
 Bliiz, Caryn 24
 Bolan, Gail 20
 Bond, Meg A. 10,24
 Boots, Bonnie 8
 Borkman, Thomasina 19
 Borkin, Meryl 16
 Boyd, Karen 19
 Boyer, Jennifer 22
 Braver, Sanford 14,19
 Brookins, Craig C. 24
 Burgoyne, Nancy 18
 Bush, Ellen G. 12
 Campbell, Rebecca 1,7
 Carson, Martie 7
 Cauce, Ana Marie 8,10,14
 Chamberlain, Patricia 6
 Chassin, Laurie 13
 Chavis, David 2,15
 Chun, Maria 4
 Csiso, David A. 12,17
 Coen, Steve 15
 Cohen, Barbara 23
 Conroy, Karen 2
 Cook, Sarah 17
 Coray, Kevin 23
 Costa, Martin 19
 Cozen, Myrna 19
 Cozens, Linda 8
 Crawford, Isaiah 6,12
 Crean, Hugh F. 12,19
 Crosby, Catherine A. 17
 Curry-El, Judy 22
 D'Ercole, Ann 1,4
 D'Rozario, Pam 7
 Davidson, William S. 1,3,13,23
 Defour, Darlene 10
 Desguin, Barbara W. 19
 Diamond, Pamela M. 13
 Do, Lan 22
 Dockett, Kathleen 4
 Doinko, Paul R. 13
 Dowell, David 7
 Dubois, David 17
 Duncan, Terry 11
 Duran, Ron 14
 Ebert, Lori 21
 Eby, Kimberly 2,19
 Eddy, Mark 6
 Eichholt, Charlene M. 7
 El-Faizy, Marjan 7,9
 Elias, Maurice 8
 Embree, Melody G. 1,2,7
 Englund, Susan 21
 Erdal, Kristi 5
 Fagot, Beverly 6
 Farguharson, Andy 12,24
 Fawcett, Stephen B. 15
 Feis, Carolyn L. 18
 Felton, Barbara 7
 Finch, John 5
 Fine, Michelle 10
 Fischer, Karla 7,13
 Fisher, Adrian 7
 Fisher, Alban 24
 Fisher, Phil 11
 Fitzpatrick, Pamela 19
 Forgatch, Marton 12
 Foster-Fishman, Penny 17
 Francisco, Vincent T. 15
 Freudenberg, Nicholas 19
 Furuyama, Renee 15
 Gallinsky, Ellen 23
 Garcia, Gloria 7
 Gardner, William 20
 Garrett, Naomi R. 18
 Gartner, Audrey 14
 Gensheimer, Leah K. 8,24
 Gersten, Joanne 13
 Goldklang, Dorothy 19
 Goldman, Charles 22
 Goldman, Ruth 16
 Gonzales, Nancy A. 1,8
 Gorman-Smith, Debbie 5
 Goza, Barbara 8
 Grant, Kathy 8
 Griffin, William 20
 Gropenbacher, Nancy 20
 Guarnaccia, Charles A. 5
 Gulcur, Leyla 23
 Hall, Christine Iijima 3,10
 Hallman, William 22
 Hanacek, Betty 9
 Handelsman, Mitchell M. 18
 Harrison, Janet 20
 Heil, William B. 2,8
 Henderson, Earron 12
 Herring, Lee 16
 Hessol, Nancy 20
 Hill, Jean 8
 Hinton, Ivora 22
 Hobfoll, Stevan E. 11
 Hosch, Harmon M. 9
 Howes, Carolee 23
 Hudson, Suzan K. 16
 Hughes, Diane 23
 Hughey, Joseph 22
 Iscoe, Ira 12
 Israel, Barbara A. 19
 Jacob, M. 20
 Janz, Nancy 19
 Jason, Leonard 21
 Johnston, Judy 15
 Julien, Marisa 16
 Foster-Fishman, Penny 17
 Francisco, Vincent T. 15
 Freudenberg, Nicholas 19
 Furuyama, Renee 15
 Gallinsky, Ellen 23
 Garcia, Gloria 7
 Gardner, William 20
 Garrett, Naomi R. 18
 Gartner, Audrey 14
 Gensheimer, Leah K. 8,24
 Gersten, Joanne 13
 Goldklang, Dorothy 19
 Goldman, Charles 22
 Goldman, Ruth 16
 Gonzales, Nancy A. 1,8
 Gorman-Smith, Debbie 5
 Goza, Barbara 8
 Grant, Kathy 8
 Griffin, William 20
 Gropenbacher, Nancy 20
 Guarnaccia, Charles A. 5
 Gulcur, Leyla 23
 Hall, Christine Iijima 3,10
 Hallman, William 22
 Hanacek, Betty 9
 Handelsman, Mitchell M. 18
 Harrison, Janet 20
 Heil, William B. 2,8
 Henderson, Earron 12
 Herring, Lee 16
 Hessol, Nancy 20
 Hill, Jean 8
 Hinton, Ivora 22
 Hobfoll, Stevan E. 11
 Hosch, Harmon M. 9
 Howes, Carolee 23
 Hudson, Suzan K. 16
 Hughes, Diane 23
 Hughey, Joseph 22
 Iscoe, Ira 12
 Israel, Barbara A. 19
 Jacob, M. 20
 Janz, Nancy 19
 Jason, Leonard 21
 Johnston, Judy 15
 Julien, Marisa 16
 Kalafat, John 8
 Kanasty, Krzysztof 20
 Kanuha, Val 7
 Kaplan, Meg 11
 Kavanagh, Kate 6
 Kelly, James G. 3,4,18,24
 Kendall, Mary 14
 Kennedy, Mellen 1,8,12
 Keys, Christopher 3,17
 Kim, Robert H. C. 4
 Kim, Nichol 4,5
 Kitano, Harry H. L. 4
 Kliever, Wendy 5
 Kline, Marsha L. 11,23
 Kohn, Laura 22
 Kosciw, Joe 23
 Kuklinski, Margaret 16
 Kuperminc, Gabriel 20
 Lateur, Diane 20
 Lagos, Nuria Ciofalo 8
 Lardon, Cecile 4
 Lavoie, Francine 20
 Lease, A. Michele 6
 Lengua, Lilliana 14
 Leone, Peter 22
 Lieber, Eli 6
 Linney, Jean Ann 3,5,11
 Lipsey, Mark W. 8
 Long, Beverly B. 3
 Loo, Chaisa 4
 Luke, Douglas 8,16
 Lustig, Julie 5,20
 Lykes, M. Brinton 3
 Madison, Sybil 16
 Magana, Belizario 20
 Manos, Michael 15
 Marin, Gerardo 10
 Martin, G. 20
 Mason, Craig 8
 Maton, Kenneth I. 3,16
 McElroy, Angela 22

McElroy, Teresa Dingus 21
 McFadden, Lisa 12
 Medvene, Louis 14
 Meissen, Gregory J. 14,16
 Michaels, Marcia L. 1,8
 Milburn, Norweta 4
 Mock, Lynne H. 4
 Monaghan, Terry 2,21
 Moore, Thom 17
 Moraes, Ana Motta 9
 Moroney, Robert 13
 Morris, Anne 1,9
 Mulvey, Anne 3,10,24
 Naylor, Kelly 1,9
 Newbrough, J. R. 13,17
 Nishimoto, Renee 9
 Nissim-Sabat, Denis 18
 Norris, Fran 7,9,20
 Norton, Shelley 22
 O'Connor, Patricia 2,3
 O'Donnell, Clifford R. 15
 O'Gorman, Robert T. 13
 Ornelas, Jose 21
 Ortiz-Torrez, Blanca 3
 Owens, Johnie 4
 Paine, Adrienne L. 15
 Patterson, Gerald R. 6,11,20,23
 Pellman, Julie 9
 Phillips, Deborah 23
 Phillips, Ruby S. C. 6
 Piotrkowski, Chaya 23
 Powell, Thomas 14
 Raftery, Yvonne 4
 Ramirez, Jorge I. 1,9
 Ramirez, Rafael 13
 Ramos, Gloria 6
 Ramsey, Betsy 11
 Rapkin, Bruce 5,11
 Rappaport, Julian 12
 Reed, Ray 18
 Reich, John W. 5
 Reid, John B. 11,12,20
 Reinsch, Sibylle 7,9
 Reischl, Thomas M. 23
 Reppucci, N. Dickon 17
 Rhodes, Jean 21
 Ribisl, Kurt 2,8,21
 Richards, Doug 16
 Riessman, Frank 14
 Riley, Joel L. 18
 Roberts, Bruce B. 15
 Roberts, Richard N. 21
 Roberts-Gray, Cynthia 9
 Robinson, W. LaVome 6
 Rogosch, Fred 13
 Roosa, Mark W. 8,9,20,21,24
 Rosario, Margaret 11
 Rotheram-Borus, Mary Jane 4,11
 Roze, Pat 7
 Ruck-Ross, Holly 6
 Rutnik, Carton 21
 Salem, Deborah A. 16
 Salina, Doreen 6,21
 Salzer, Mark S. 6,12
 Sandler, Irwin N. 1,5,9,13,20,23
 Scally, Joe 24
 Scheinfeld, Sandra 4
 Schmid, Kathleen 22
 Schnee, Steven B. 12
 Schneider, Margaret 10,24
 Schwartz-Dodek, Linda 24
 Seidman, Ed 11,16
 Sethi, Renuka 4
 Shell, Rita 21
 Shinn, Beth 1,4,23
 Short, Jerome L. 9
 Silverman, Phyllis 14
 Smith, Christine 12
 Smith, Ursula 22
 Snow, David L. 5,10,11,23
 Snowden, Lonnie 3,10
 Solarz, Andrea L. 4,18
 Solomon, Hope 22
 Somera, Lina Beth 10
 Spaccarelli, Steve 21
 Speer, Paul 22
 Stark, Louisa R. 4,5
 Stein, Catherine H. 12,17
 Stoolmiller, Mike 11
 Suarez-Balcazar, Yolanda 12
 Sulliman, Layla 12
 Sullivan, Cris M. 13,23
 Swift, Carolyn W. 7
 Syme, Geoff 7
 Tebes, Jacob K. 10,11
 Terenzio, Marion 21
 Tharp, Roland G. 15
 Thorshelm, Howard I. 15
 Tien, Jenn Yun 13
 Tolan, Patrick H. 5,9,24
 Tolliver, Derise 18
 Toro, Paul 5
 Trickett, Edison J. 12,14,16,22
 Underwood, Alex 22
 van Uchelen, Collin 1,9
 Walker, Hill 11
 Wandersman, Abraham 22
 Ward, Marcia 17
 Watkins-Ferrill, Peggy 6,8
 Watts, Roderick J. 6,12
 Weinstein, Rhona S. 16
 Wenzel, Suzanne L. 9,13
 White, Barbara 16
 Whitebook, Marcy 23
 Wilcox, Brian L. 13,18
 Williams, Rhonda K. 16
 Wilson, Kathleen 15
 Wilson, Melvin N. 1,22
 Wilson, Midge 9
 Wolchik, Sharlene 1,5,14,19
 Wolfe, Susan M. 18
 Wolff, Thomas 2,14,15
 Worden, William 14
 Wordes, Madeline 8,23
 Work, William C. 5,14
 Wrabetz, Amy B. 5
 Yeich, Susan C. 1,10
 Zautra, Alex J. 1,5
 Zeigler, Richard M. 2,10
 Zimmerman, Marc A. 3,19